

Does your
Power BI model
look like spaghetti
as well?

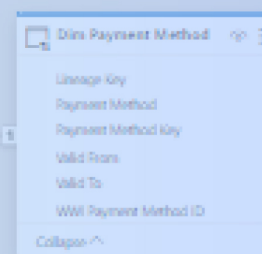
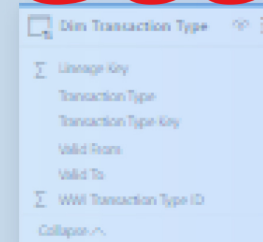
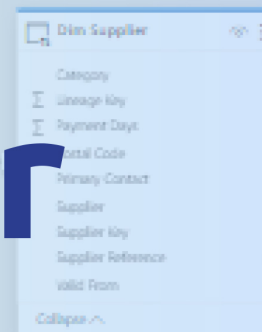
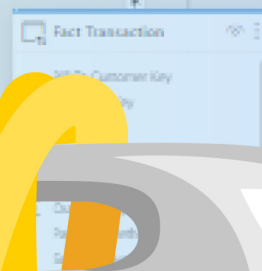
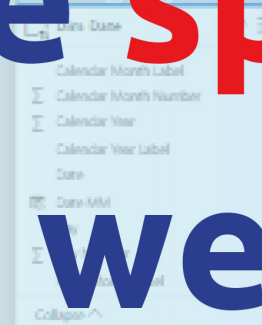
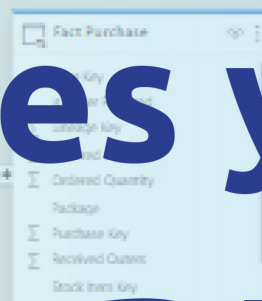
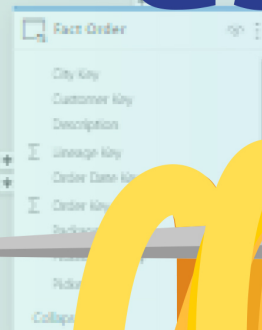

Let's fix this!

just add a new layout

New Layout

All tables



Set up your layout

Drag tables to the canvas to add them to your layout or select Auto layout and we'll do it for you.

Auto layout



Add a fact table
and click ‘add related tables’

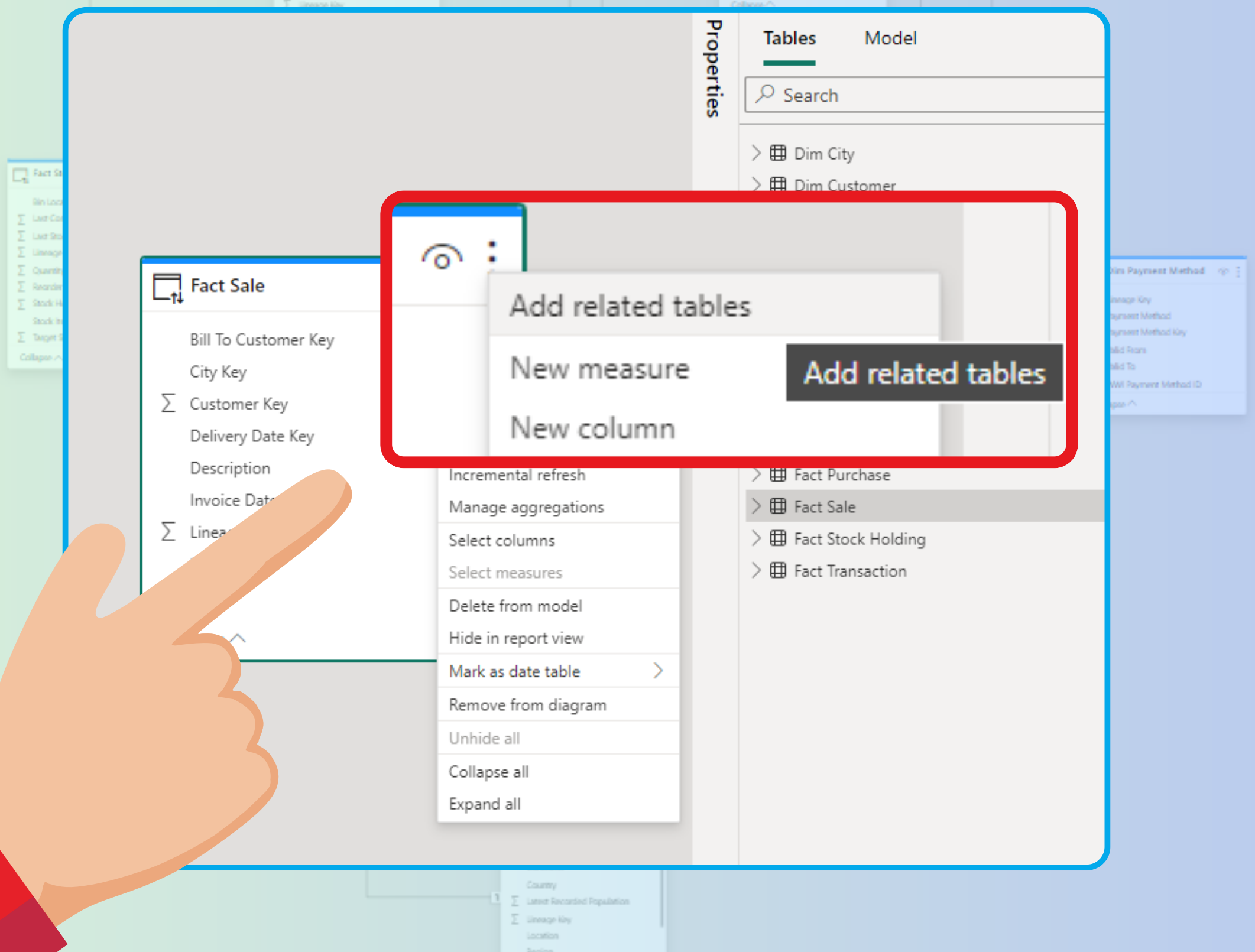

Whoop, there it is!
a perfect star-schema layout

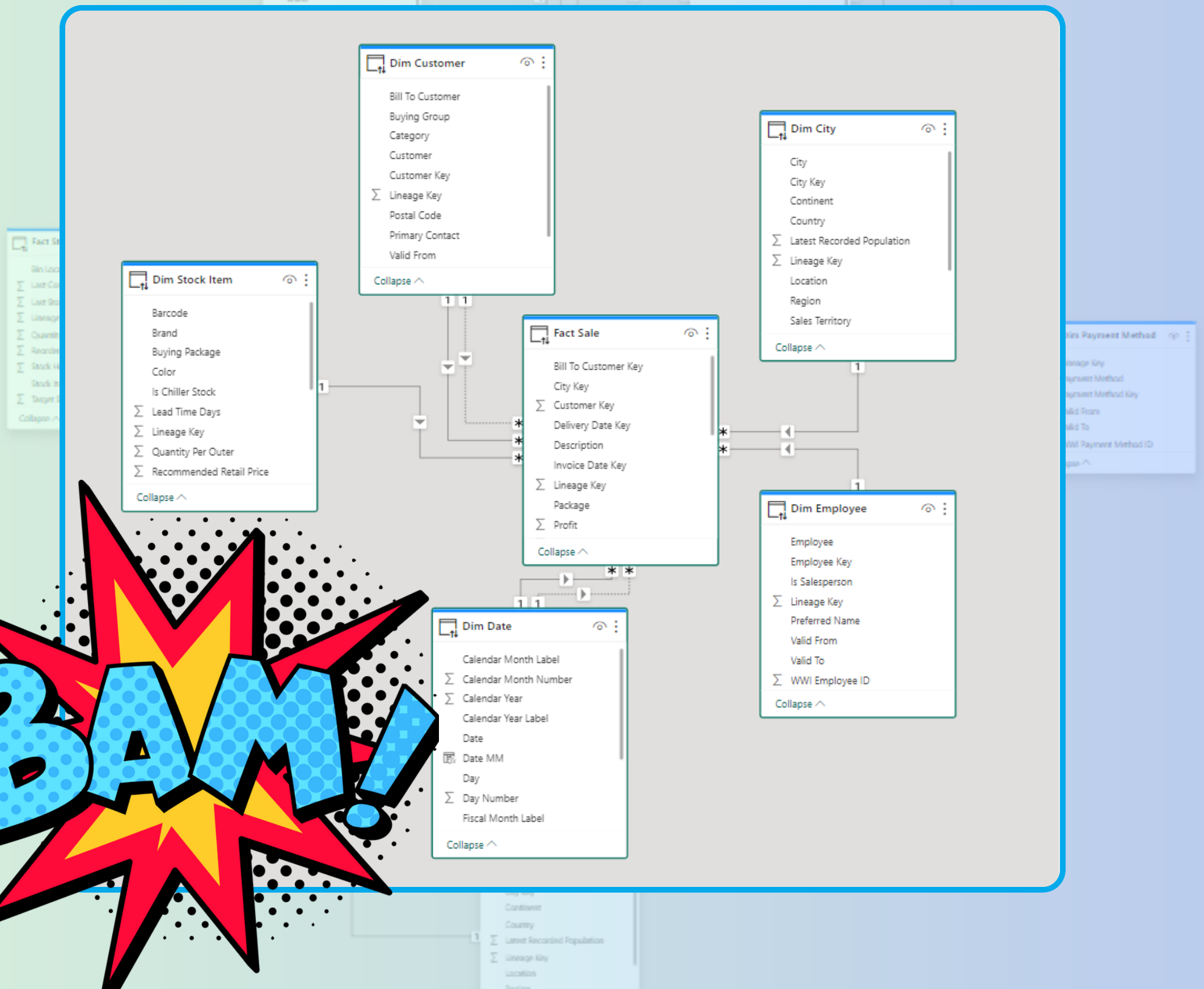

Let's tidy up

Select tables with 'Ctrl + A'
then click 'Collapse'

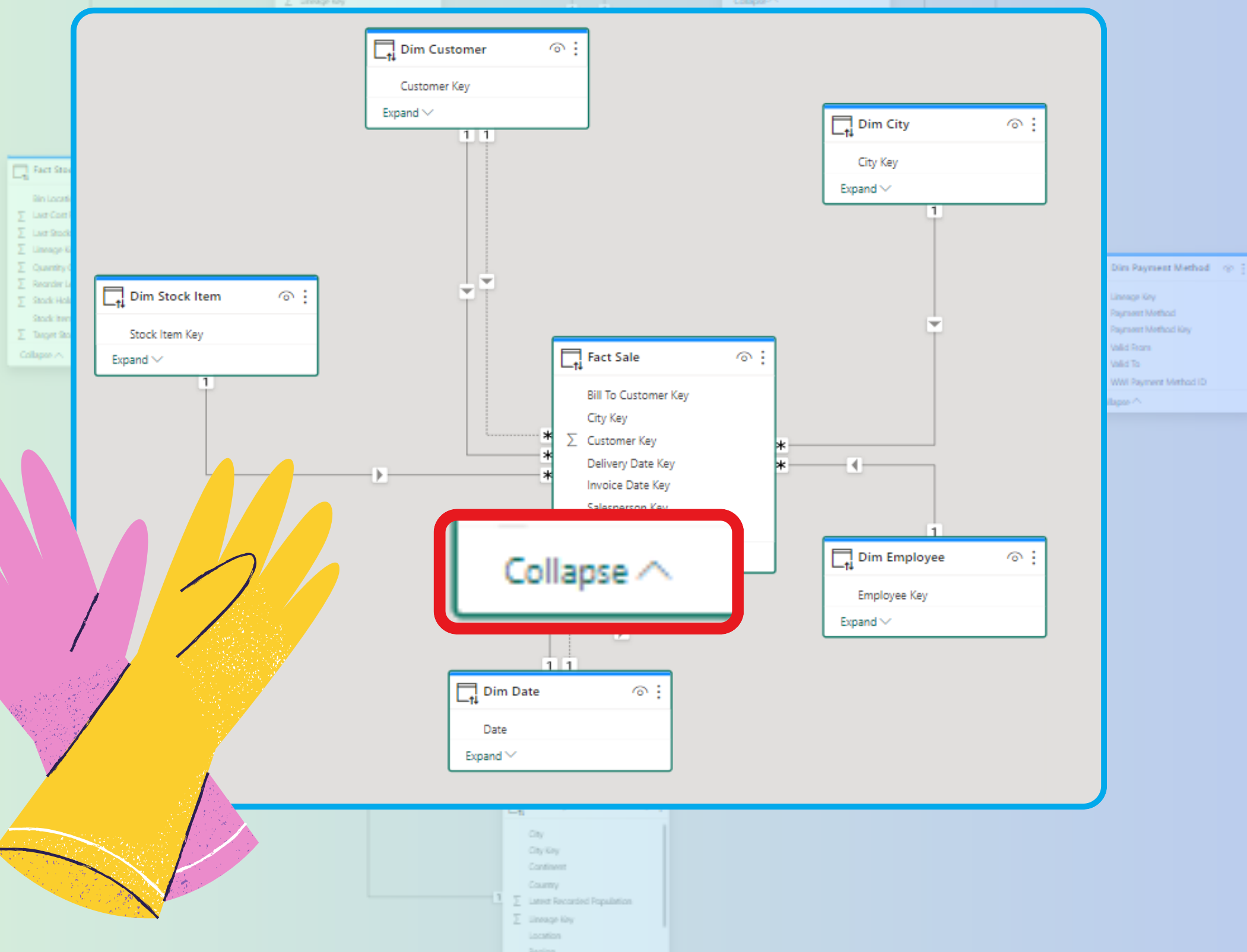



IK WIL EEN DASHBOARD

Repost if you found
this helpful

